

This official copy issued on 8 April 2008 shows the state of this title plan on 8 April 2008 at 10:16:54. It is admissible in evidence to the same extent as the original (s.67 Land Regis
 This title plan shows the general position, not the exact line, of the boundaries. It may be subject to distortions in scale. Measurements scaled from this plan may not match measureme
 This title is dealt with by Land Registry, Coventry Office.

Land Registry
Official copy of
title plan

Title number **WR116095**
Ordnance Survey map reference **SO9569SE**
Scale **1:1250**
Administrative area **Worcestershire: Bromsgrove**

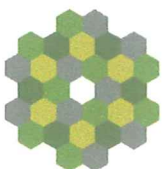

© Crown Copyright. Produced by Land Registry. Reproduction in whole or in part is prohibited without the prior written permission of Ordnance Survey. Licence Number 100026316.

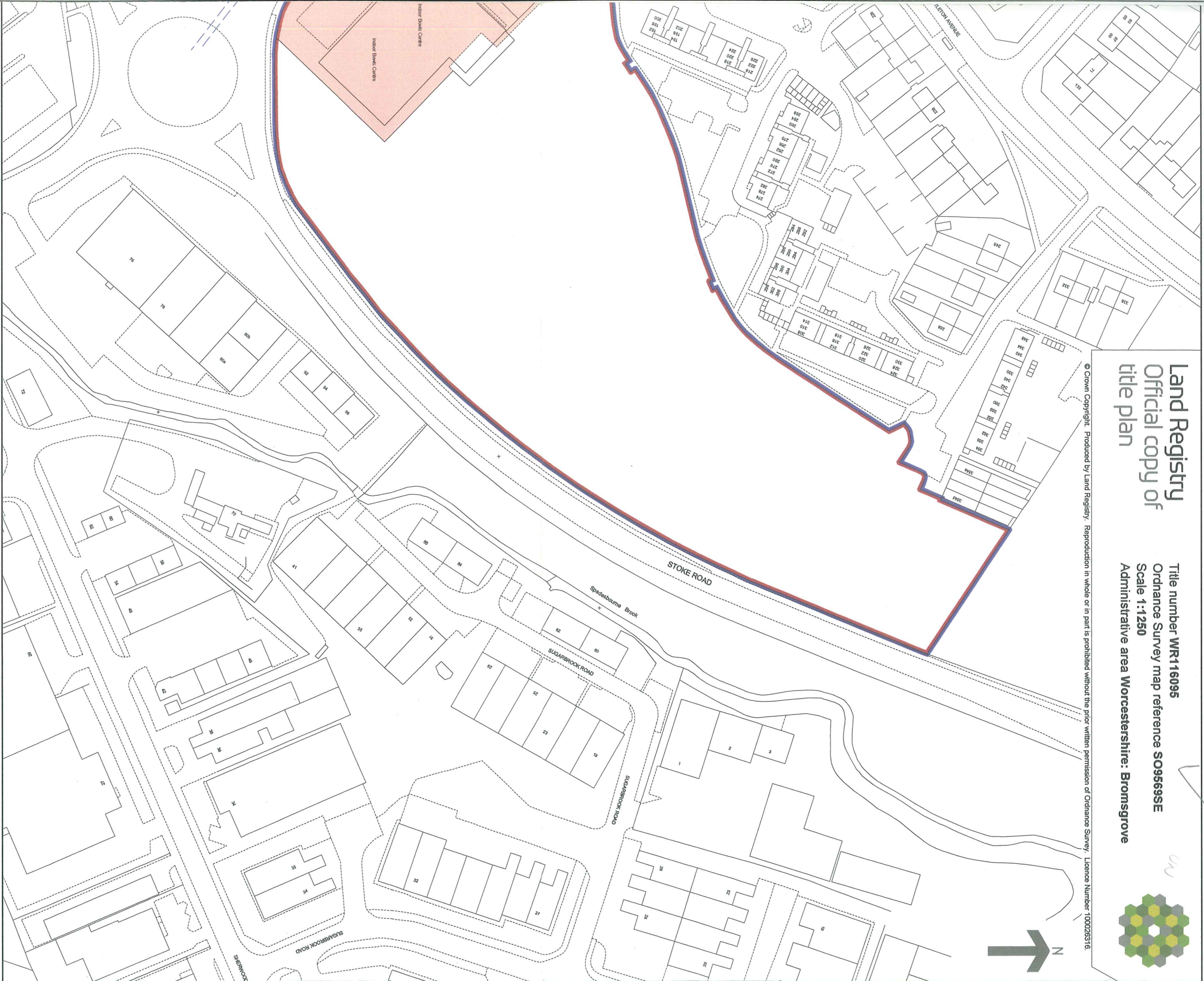

Registration Act 2002).
discrepancies between the same points on the ground. See Land Registry Public Guide 19 - Title Plans and Boundaries.